

Operation Specifications

| | |
|-----------------------------|--|
| Max Working Pressure | 200 PSI [13.8 bar] |
| Max Temperature | 250 °F [121.1 °C] |
| Compatible Fluids | Compatible with petroleum and alcohol fuels, petroleum and synthetic motor oils, and engine coolants (ethylene glycol) |

Rebuild Kits and Torque Recommendations

| Family / Size | S  | S  | L  | L  | XL  |
|--|--|---|--|--|---|
| AN Size | -6 AN & - 8 AN | -6 AN & - 8 AN | -10 AN & - 12 AN | -10 AN & - 12 AN | -16 AN & - 20 AN |
| Rebuild Kit | 09-0900-KIT | 09-0900-KIT | 09-0940-KIT | 09-0940-KIT | 09-0980-KIT |
| End Cap Screw | 8-32 x 1/2" Long | 8-32 x 1/2" Long | 10-24 x 1/2" Long | 10-24 x 1/2" Long | 1/4-20 x 1/2" Long |
| End Cap Screw Torque | 14-16 in-lb | 14-16 in-lb | 16-18 in-lb | 16-18 in-lb | 24-28 in-lb |
| Panel Mount Thread | - | 10-24 | - | - | - |
| Max Torque, Panel Mount Screws | - | 30 in-lb | - | - | - |
| Panel Mount Loctite | - | Loctite 222 (Purple) | - | - | - |
| Max Torque, Bulkhead Nut -10 AN | - | - | - | 10 ft-lb | - |
| Max Torque, Bulkhead Nut -10 AN | - | - | - | 10 ft-lb | - |

TO CHANGE HANDLE ORIENTATION:

1. Turn handle 45° so that hole in handle is above the set screw.
2. Use a .050" hex key and remove set screw through the hole.
3. Determine the desired handle orientation (See p. 2). Rotate handle to desired position, then turn 45° so that the hole in the handle is above the necessary hole for the set screw.
4. Clean threads of any dirt, grease, or oil and apply Loctite 222 (purple) to 1st four set screw threads.
5. Install set screw in desired position. Install set screw deep enough that it engages the slot in the handle and allows handle to turn smoothly.

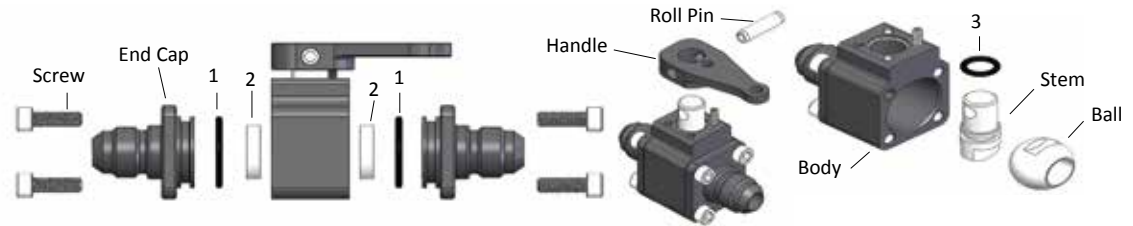
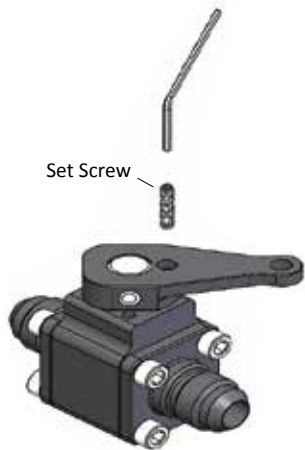

Rebuild Kits include End Cap O-Rings (Item 1), Ball Seals (Item 2), and Stem O-Ring (Item 3).

1. For best performance, lubricate O-Rings and Ball Seals (Items 1, 2, and 3) with oil prior to installation.
2. Remove Screws (Qty. 8) to separate End Caps from body.
3. To replace Stem O-Ring (Item 3 / Qty. 1), push out Roll Pin and remove Handle. Remove Ball and push Stem down and out of Body. Install new O-Ring on Stem. Reassemble Stem to its original location. Note orientation of Stem tab and Ball slot and ensure that tab is inserted in slot.
4. Reassemble Handle in desired orientation and press in Roll Pin from counterbored side of Handle.
5. Replace End Cap O-Rings (Item 1 / Qty. 2) and Ball Seals (Item 2 / Qty. 2) and reassemble End Caps to Body.
6. Install Screws and torque to value shown in table above for End Cap Screw Torque.

Dimensions

Handle Configurations

STANDARD & BULKHEAD

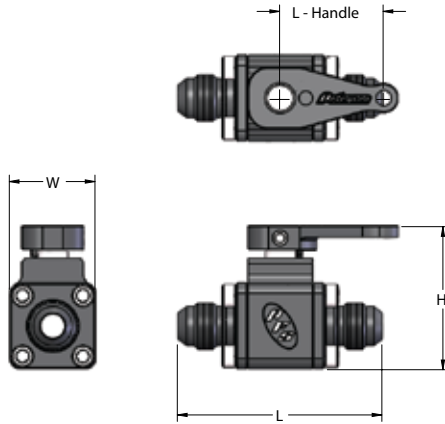

FLANGE MOUNT

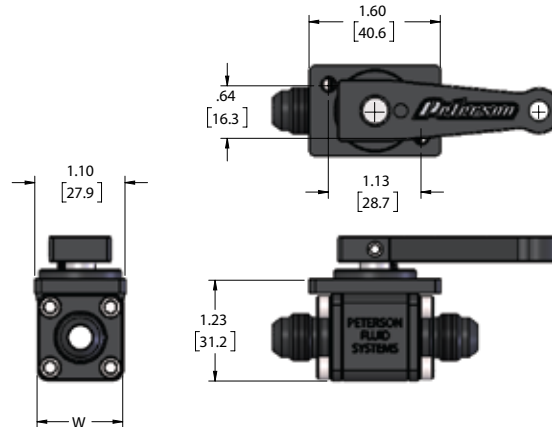

Handle rotates 90° and can be configured in four different orientations

Handle @45°
Set Screw
Visible

Valve Open

Valve Closed

1.

Set screw at lower right



2.

Set screw at lower left



3.

Set screw at upper left



4.

Set screw at upper right



| Part No. | Type | Fittings | Weight (g) | Length | Width | Height | L-Handle |
|----------|-----------|---------------------|------------|--------------|-------------|-------------|--------------|
| 09-0900 | Small | -6AN | 84.2 | 2.49 (63.3) | 1.05 (26.7) | 1.74 (44.2) | 1.26 (32.0) |
| 09-0903 | Small | -6AN x 6AN Female | 99.5 | 2.73 (69.3) | 1.05 (26.7) | 1.74 (44.2) | 1.26 (32.0) |
| 09-0910 | S-Panel | -6AN | 96.9 | 2.49 (63.3) | 1.05 (26.7) | 1.74 (44.2) | 2.00 (50.8) |
| 09-0920 | Small | -8AN | 92.6 | 2.70 (68.6) | 1.05 (26.7) | 1.74 (44.2) | 1.26 (32.0) |
| 09-0923 | Small | -8AN x 8AN Female | 119.7 | 2.94 (74.7) | 1.05 (26.7) | 1.74 (44.2) | 1.26 (32.0) |
| 09-0930 | S-Panel | -8AN | 105.3 | 2.70 (68.6) | 1.05 (26.7) | 1.74 (44.2) | 2.00 (50.8) |
| 09-0940 | Large | -10AN | 155.7 | 3.25 (82.6) | 1.38 (35.0) | 2.05 (52.1) | 2.00 (50.8) |
| 09-0941 | Bulkhead | -10AN | 183.2 | 4.11 (104.4) | 1.38 (35.0) | 2.05 (52.1) | 2.00 (50.8) |
| 09-0943 | Large | -10AN x 10AN Female | 166.8 | 3.49 (88.7) | 1.38 (35.0) | 2.05 (52.1) | 2.00 (50.8) |
| 09-0960 | Large | -12AN | 171.2 | 3.46 (87.9) | 1.38 (35.0) | 2.05 (52.1) | 2.00 (50.8) |
| 09-0961 | Bulkhead | -12AN | 214.1 | 4.39 (111.5) | 1.38 (35.0) | 2.05 (52.1) | 2.00 (50.8) |
| 09-0963 | Large | -12AN x 12AN Female | 190.0 | 3.62 (91.9) | 1.38 (35.0) | 2.05 (52.1) | 2.00 (50.8) |
| 09-0980 | Ex. Large | -16AN | 526.5 | 4.28 (108.7) | 2.40 (61.0) | 2.91 (73.9) | 5.00 (127.0) |
| 09-0983 | Ex. Large | -16AN x 16AN Female | 562.9 | 4.88 (123.9) | 2.40 (61.0) | 2.91 (73.9) | 5.00 (127.0) |
| 09-0990 | Ex. Large | -20AN | 563.0 | 4.38 (111.2) | 2.40 (61.0) | 2.91 (73.9) | 5.00 (127.0) |

Dimensions are in inches and (mm)